

COOL-FIT 2.0 Transition Tee90° PE/brass With female thread Rp

Model:

- Pre-insulated, PE100, SDR11, metric
- Brass CuZn40Pb2 with female thread Rp
- Insulation made from GF HE foam
- Impact resistant. Color: black
- A: Electrofusion Fitting with integrated sealing lip, for a water and vapour tight sealing
- B: Spigot Fitting with free end (separate electrofusion fitting needed for joining)

d (mm)	D (mm)	d/D (mm)	Thread Type	Size (inch)	DN (mm)	SDR	PN (bar)	Code
63	110	63/110	Rp	2	50	11	16	738 954 061
75	125	75/125	Rp	2	65	11	16	738 954 062
90	140	90/140	Rp	2	80	11	16	738 954 063
110	160	110/160	Rp	2	100	11	16	738 954 064
140	200	140/200	Rp	2	125	11	16	738 954 066

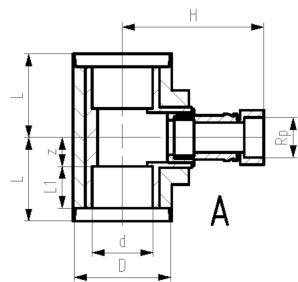

L (mm)	L1 (mm)	z (mm)	H (mm)	closest inch (inch)	Type
97	48	29	212	2	A
110	55	36	193	2 ½	A
124	62	43	210	3	A
148	72	57	223	4	A
	84	447	316	5	B

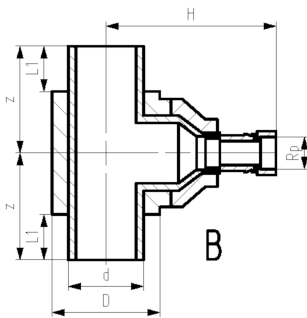

The technical data are not binding. They neither constitute expressly warranted characteristics nor guaranteed properties nor a guaranteed durability. They are subject to modification. Our General Terms of Sale apply.

Georg Fischer Piping Systems Ltd, Postfach, CH-8201 Schaffhausen/Switzerland

Phone +41 -(0)52-631 1111

e-mail: info.ps@georgfischer.com

Internet: <http://www.gfps.com>