

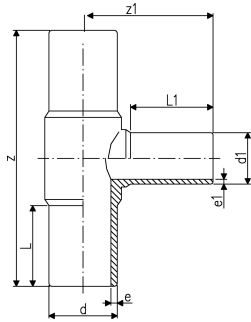

ELGEF Plus Tee 90° reduced PE100
d90-d315mm / SDR17 / Long version

Model:

- Pressure rating: 10 bar water / 5 bar gas
- Fittings are injection moulded



d	d1	SDR	PN	DN	Code	Weight	z	z1	L	L1	e	e1
(mm)	(mm)			(mm)		(kg)	(mm)	(mm)	(mm)	(mm)	(mm)	(mm)
90	50	17	10	80	753 201 827	0.630	275	117	79	55	5.4	3.0
90	63	17	10	80	753 200 829	0.560	275	123	79	63	5.4	3.8
90	75	17	10	80	753 201 855	0.580	286	132	80	75	5.4	4.5
110	63	17	10	100	753 200 828	1.010	318	147	82	63	6.6	3.8
110	75	17	10	100	753 200 131	1.029	324	155	85	74	10.0	6.8
110	90	17	10	100	753 200 832	0.941	318	158	82	79	6.6	5.4
125	90	17	10	100	753 201 132	1.560	354	165	90	82	11.4	8.2
125	110	17	10	100	753 200 133	1.500	354	167	90	85	11.4	10.0
160	63	17	10	150	753 200 834	2.554	330	130	86	63	9.5	3.8
160	75	17	10	150	753 200 880	1.920	420	180	105	75	9.5	4.5
160	90	17	10	150	753 200 836	1.972	410	188	98	79	9.5	5.4
160	110	17	10	150	753 200 837	2.716	410	195	98	82	9.5	6.6
180	90	17	10	150	753 200 881	2.780	484	200	110	82	10.7	5.4
180	110	17	10	150	753 200 150	4.320	486	205	110	86	10.7	6.6
180	160	17	10	150	753 200 882	5.560	484	220	110	100	18.7	9.5
200	63	17	10	200	753 201 873	6.800	500	190	122	63	11.9	3.8
200	90	17	10	200	753 201 874	6.900	500	207	122	79	11.9	5.4
200	110	17	10	200	753 201 875	5.097	500	215	122	82	11.9	6.6
200	160	17	10	200	753 201 876	7.400	500	234	122	98	11.9	9.5
225	75	17	10	200	753 200 839	7.128	555	277	120	70	13.4	4.5
225	90	17	10	200	753 200 840	4.732	555	226	127	80	13.4	5.4
225	110	17	10	200	753 200 841	4.700	555	235	127	82	13.4	6.6
225	160	17	10	200	753 200 842	5.922	555	253	127	98	13.4	9.5
225	180	17	10	200	753 200 843	7.211	550	280	120	105	13.4	10.7
250	110	17	10	250	753 201 878	8.185	575	242	130	82	14.8	6.6
250	160	17	10	250	753 201 879	9.800	575	261	130	98	14.8	9.5
315	110	17	10	300	753 200 851	15.621	695	277	150	82	18.7	6.6
315	160	17	10	300	753 200 852	12.200	695	296	150	102	18.7	9.5
315	200	17	10	300	753 200 152	17.910	690	313	155	117	18.7	11.9
315	225	17	10	300	753 200 153	16.035	690	320	155	125	18.7	13.4
315	250	17	10	300	753 200 854	15.500	695	325	150	130	18.7	14.8

The technical data are not binding. They neither constitute expressly warranted characteristics nor guaranteed properties nor a guaranteed durability. They are subject to modification. Our General Terms of Sale apply.

Georg Fischer Piping Systems Ltd, Postfach, CH-8201 Schaffhausen/Switzerland

Phone +41 -(0)52-631 1111

e-mail: info.ps@georgfischer.com

Internet: <http://www.gfps.com>