

# Data sheet

valid from: 8/22/21

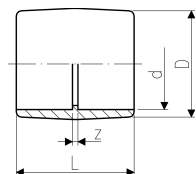

## Socket PVC-C metric

d (mm)	PN (bar)	Code	SP	Weight (kg)	z (mm)	D (mm)	L (mm)
16	16	<b>723 910 105</b>	10	0.008	3	22	31
20	16	<b>723 910 106</b>	10	0.010	3	26	35
25	16	<b>723 910 107</b>	10	0.017	3	31	41
32	16	<b>723 910 108</b>	10	0.029	3	39	47
40	16	<b>723 910 109</b>	10	0.049	3	49	55
50	16	<b>723 910 110</b>	10	0.085	3	61	65
63	16	<b>723 910 111</b>	10	0.155	3	76	79
75	16	<b>723 910 112</b>	10	0.204	4	87	92
90	16	<b>723 910 113</b>	10	0.338	5	110	107
110	16	<b>723 910 114</b>	5	0.769	5	131	132
160	16	<b>723 910 117</b>	2	1.605	8	183	180
225	10	<b>723 910 120</b>	1	3.644	10	253	248

The technical data are not binding. They neither constitute expressly warranted characteristics nor guaranteed properties nor a guaranteed durability. They are subject to modification. Our General Terms of Sale apply.

Georg Fischer Piping Systems Ltd, Postfach, CH-8201 Schaffhausen/Switzerland

Phone +41 -(0)52-631 1111

e-mail: [info.ps@georgfischer.com](mailto:info.ps@georgfischer.com)

Internet: <http://www.gfps.com>