



Flange adaptor ABS metric

Model:

- Counter part: same flange adaptor
- Gasket: profile flange gasket EPDM code no. 748 440 706-723, FKM code no. 749 440 706-723
- Gasket: flat gasket EPDM code no. 748 400 306-323
- Joining faces flat/serrated
- >d225 - maximum operating temperature: +40°C

Note:

* bevel on pipe may be needed if used with butterfly valve type 037/038/039

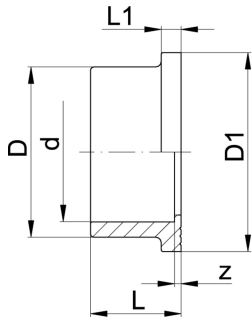

	d	d	DN	PN	Code	SP	Weight	D	D1	L	L1	z	closest inch
	(mm)	(inch)	(mm)	(bar)			(kg)	(mm)	(mm)	(mm)	(mm)	(mm)	(inch)
	20		15	10	729 790 106	10	0.007	27	34	21	6	3	½
	25		20	10	729 790 107	10	0.015	33	41	24	7	3	¾
	32		25	10	729 790 108	10	0.020	41	50	27	7	3	1
	40		32	10	729 790 109	10	0.028	50	61	30	8	3	1 ¼
	50		40	10	729 790 110	10	0.038	61	73	34	8	3	1 ½
	63		50	10	729 790 111	10	0.068	76	90	41	9	3	2
	75	2 ½	65	10	729 790 112	10	0.116	91	106	47	10	3	2 ½
	90		80	10	729 790 113	10	0.185	108	125	56	11	5	3
	110		100	10	729 790 114	10	0.305	131	150	66	12	5	4
	140	5	125	10	729 790 116	6	0.535	165	188	81	14	5	5
*	160		150	10	729 790 117	2	0.821	188	213	91	16	5	6
*	200		200	10	729 790 119	2	1.123	224	250	112	24	6	8
	225		200	10	729 790 120	2	1.330	248	274	125	25	6	8
	250		250	6	729 790 121	1	1.699	274	303	140	23	9	9
	280		250	6	729 790 122	1	2.183	307	329	151	23	5	10
	315		300	6	729 790 123	1	3.321	346	379	172	27	8	12

The technical data are not binding. They neither constitute expressly warranted characteristics nor guaranteed properties nor a guaranteed durability. They are subject to modification. Our General Terms of Sale apply.

Georg Fischer Piping Systems Ltd, Postfach, CH-8201 Schaffhausen/Switzerland

Phone +41 -(0)52-631 1111

e-mail: info.ps@georgfischer.com

Internet: <http://www.gfps.com>